

初探北陸

之設建藝 旅計築術

アートと建築とデザインの旅
はじめての、北陸

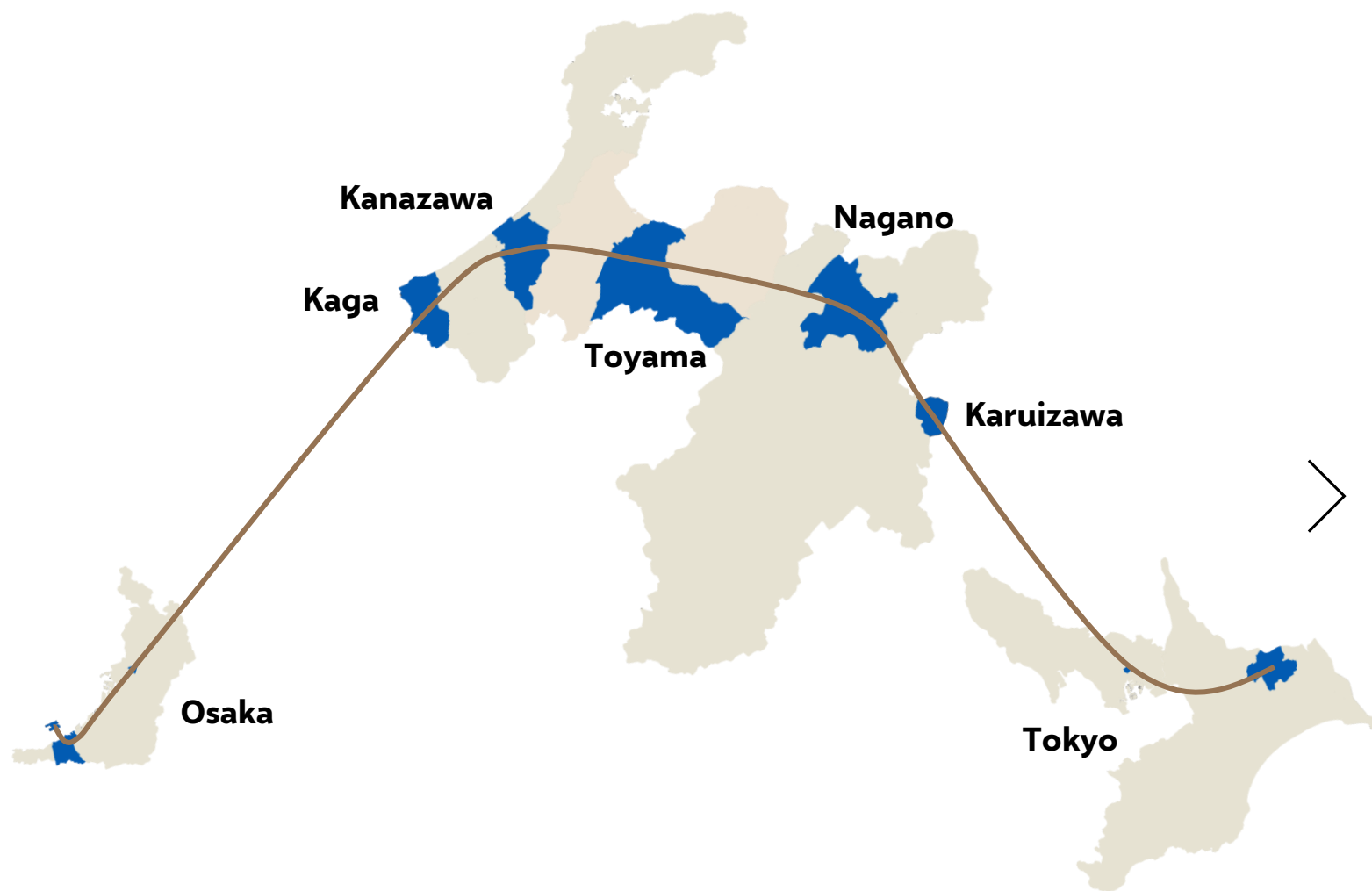

Introduction to Hokuriku

2027.02.01 – 2027.02.10

a **journey to art, architecture & design**

Itinerary

精简行程

- 1 Assemble at Narita International Airport / Tokyo Toilet Optional Tour
成田国际机场集合 / 东京公厕可选游览
- 2 Tokyo Station / Shinkansen ride to Karuizawa / Hiroshi Senju Museum Karuizawa / Hoshino Onsen Tombo No Yu
东京站 / 乘坐新干线前往轻井泽 / 轻井泽千住博美术馆 / 星野温泉通宝之汤
- 3 Stone Church / Shinkansen ride to Nagano / Shojin Cuisine Dinner
石之教堂 / 乘坐新干线前往长野 / 精进料理晚餐
- 4 Zenkoji Temple / Nagano Prefectural Art Museum / Higashiyama Kaii Gallery / Shinkansen ride to Toyama
善光寺 / 长野县立美术馆 / 东山魁夷馆 / 乘坐新干线前往富山
- 5 Toyama Prefectural Museum of Art & Design / Koshinokuni Museum of Literature / Toyama Glass Art Museum / Shinkansen ride to Kanazawa
富山县美术馆 / 高志之国文学馆 / 富山玻璃美术馆 / 乘坐新干线前往金泽
- 6 Kaga Katayamazu City Spa / Yamashiro Onsen / Higashi Chaya District
加贺片山津温泉总汤 / 山代温泉 / 东茶屋街
- 7 KAMU Kanazawa / Kanazawa 21st Century Museum of Contemporary Art / D. T. Suzuki Museum / National Crafts Museum / Yoshiro and Yoshio Taniguchi Museum of Architecture
金泽KAMU / 金泽21世纪美术馆 / 铃木大拙馆 / 国立工艺馆 / 谷口吉郎/吉生纪念金泽建筑馆
- 8 Kenroku-en Garden / Kanazawa Umimirai Library / Ishikawa Prefectural Library / Shinkansen ride to Osaka
兼六园 / 金泽海未来图书馆 / 石川县立图书馆 / 乘坐新干线前往大阪
- 9 Free Day
自由活动
- 10 Dismiss at Kansai International Airport
关西国际机场解散

Price

费用

all-in plan

RM 8600 – by 31st Aug. 2026

RM 9900 – standard price

basic plan

(excluding flight tickets)

RM 5999 or JPY 239000

– by 31st Aug. 2026

RM 6670 or JPY 266000

– standard price

全包套餐

RM 8600 – 2026年8月31日前

RM 9900 – 标准价

基础套餐 (不含机票)

RM 5999 或 JPY 239000

– 2026年8月31日前

RM 6670 或 JPY 266000

– 标准价

Terms

条件

application closes

1st January 2027

price includes round-trip flight tickets (with at least 20kg luggage) / transportation / accommodation / necessary entrance tickets / partial meals / lecture and study tour fee / guide and translations

price excludes transportation before and after the tour / partial meals / personal consumptions (laundry, communications, beverage, room services or other purely personal natures and optional tours, etc.)

报名截止日期

2027年1月1日

费用包含 往返飞机票(含至少二十公斤托运行李) · 全程交通与住宿 · 景点的首道门票 · 部分膳食 · 讲座与视察费 · 向导与翻译

费用不包含 集合前与解散后的交通费用 · 部分膳食 · 个人消费(如洗衣、电话、行程外饮食、行程外交通, 个人保险费用等)



Night 1



Klein Dytham Architecture
Irie Miyake Architects and Engineers

Toggle Hotel Suidobashi or equivalent
Toggle酒店水道桥或相同

Night 2



Tatsuro Sasaki Architects

BEB5 Karuizawa by Hoshino Resorts or equivalent
星野集团轻井泽BEB5或相同

Night 3



Zenkoji Temple Accommodation or equivalent
善光寺宿坊或相同

Night 4



Toyoko Inn Toyama Station Shinkansen Exit 2 or equivalent
东横Inn富山站新干线口2号店或相同

Accommodation 住宿



Night
5 ~ 7



Yusuke Seki Studio

KUMU Kanazawa by The Share Hotels or equivalent
The Share Hotels金泽KUMU或相同

Night
8 ~ 9



Togo Murano
Kengo Kuma and Associates

Hotel Royal Classic Osaka or equivalent
大阪皇家古典酒店或相同

Accommodation 住宿



Tokyo Toilet (Optional)

东京公厕 (可选)

Fumihiko Maki / Junko Kobayashi / Kashiwa Sato
/ Kazuo Sato / Kengo Kuma / Marc Newson /
Masamichi Katayama / Miles Pennington / Nao
Tamura / NIGO® / Shigeru Ban / Sou Fujimoto /
Tadao Ando / Takenosuke Sakakura / Tomohito
Ushiro / Toyo Ito

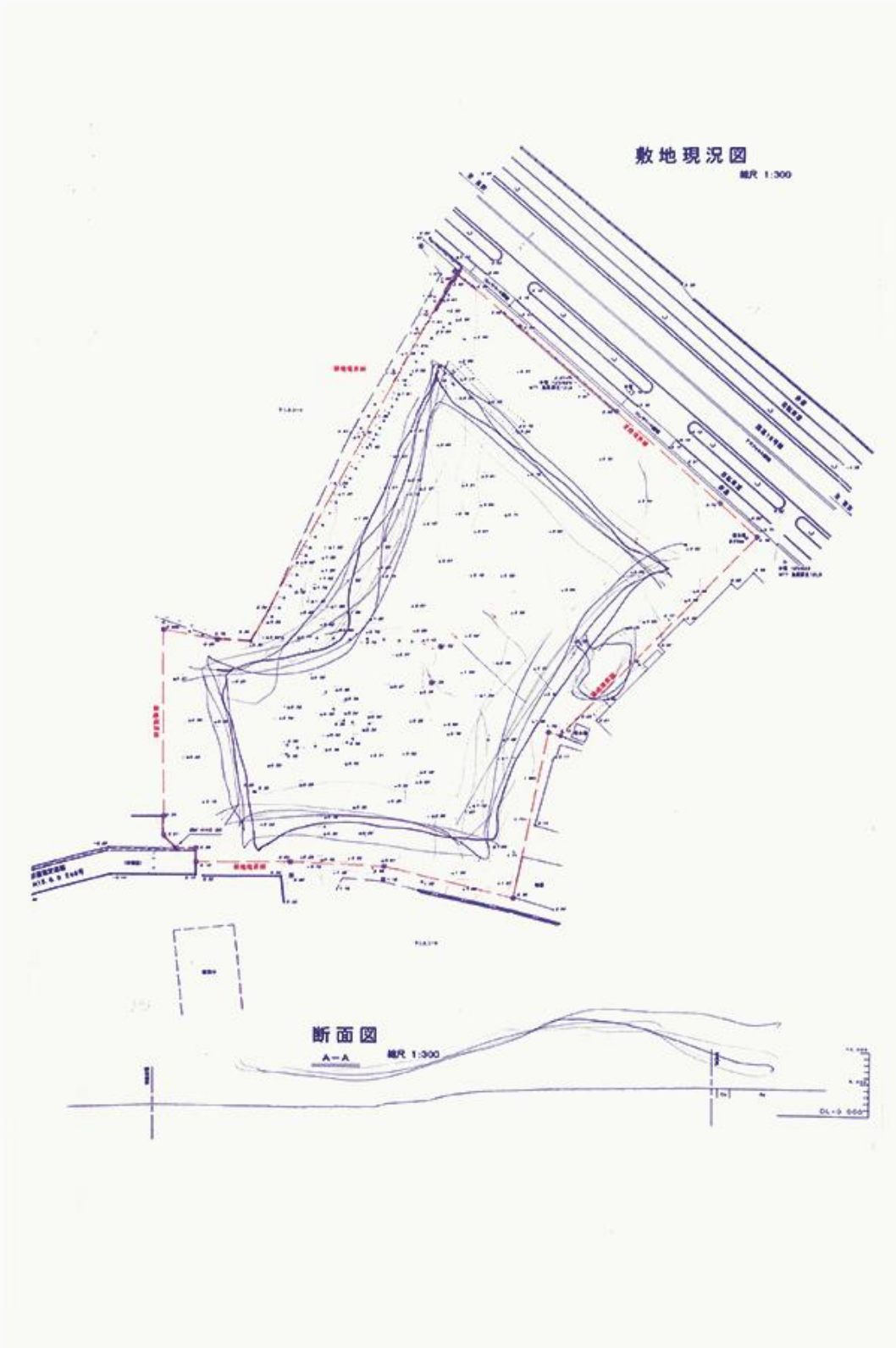

Hiroshi Senju Museum Karuizawa

轻井泽千住博美术馆

Ryue Nishizawa 西泽立卫

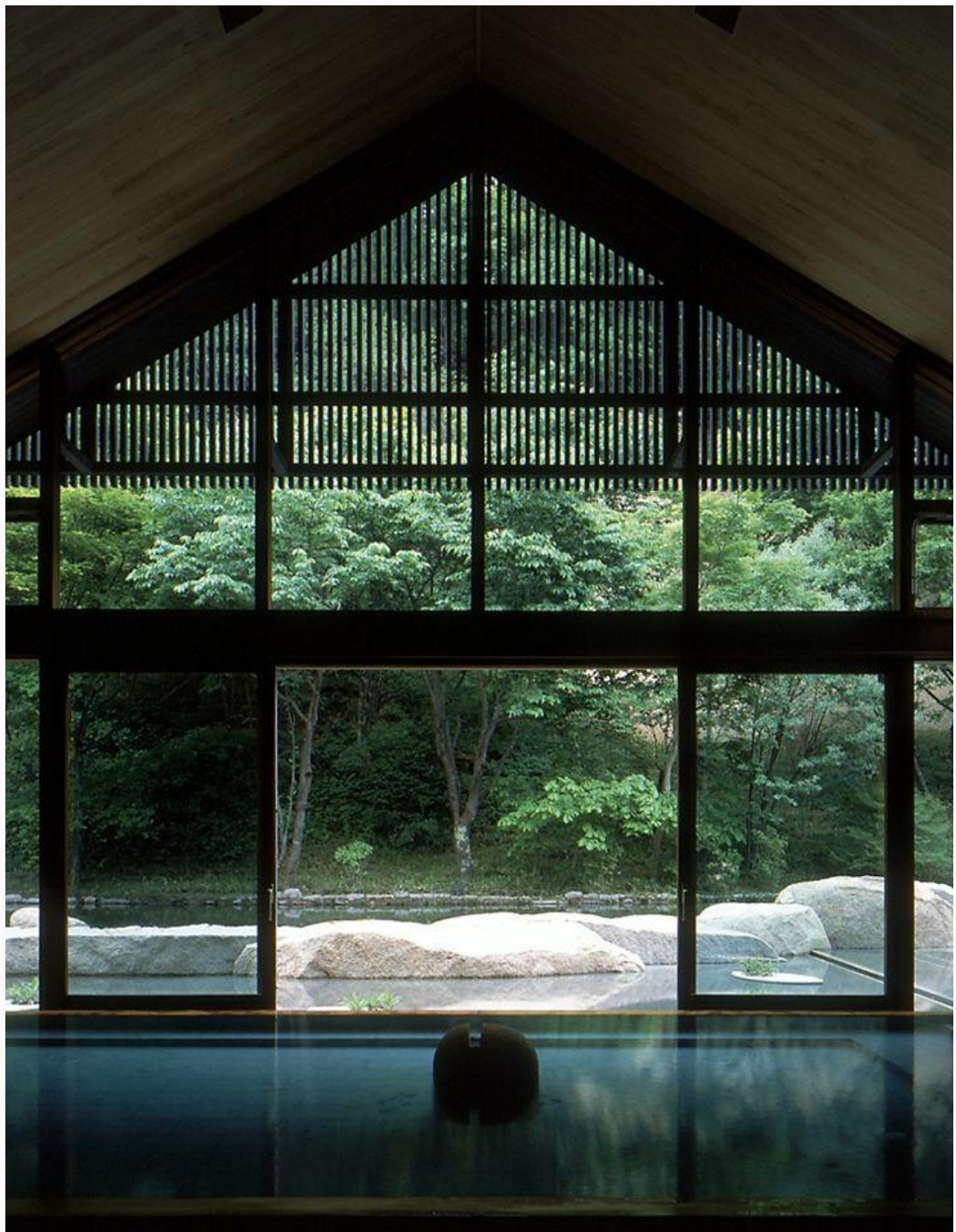

Hoshino Onsen Tombo No Yu

星野温泉通宝之汤

Azuma Architects & Associates 东环境建筑研究所



Stone Church

石之教堂

Kendrick Kellogg 肯德里克 凯洛格



Zenkoji Temple

善光寺



Nagano Prefectural Art Museum

長野県立美術館

Plants Associates Inc. 宮崎浩



Higashiyama Kai Gallery

东山魁夷馆

Yoshio Taniguchi 谷口吉生

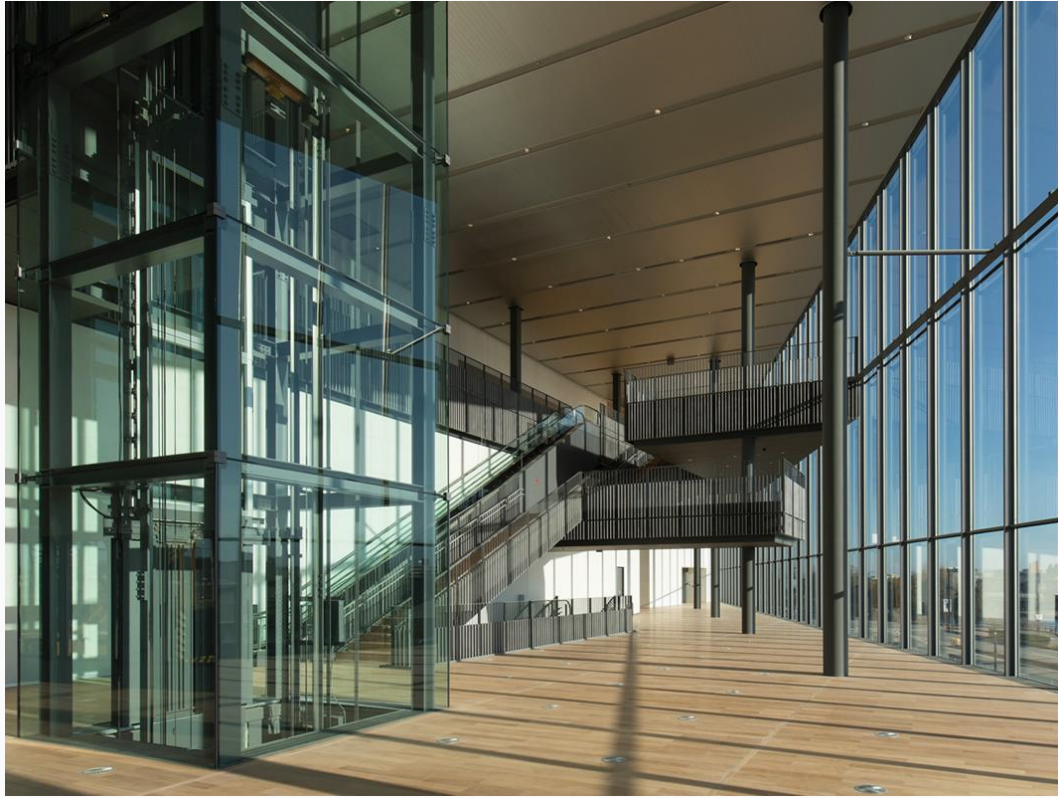

Toyama Prefectural Museum of Art & Design

富山县立美术馆

Hiroshi Naito 内藤广



Koshinokuni Museum of Literature

高志之国文学馆

Coelacanth and Associates



Toyama Glass Art Museum

富山玻璃美术馆

Kengo Kuma and Associates 隈研吾



Kaga Katayamazu City Spa

加贺片山津温泉总汤

Yoshio Taniguchi 谷口吉生



Yamashiro Onsen

山代温泉

Hiroshi Naito 内藤 广

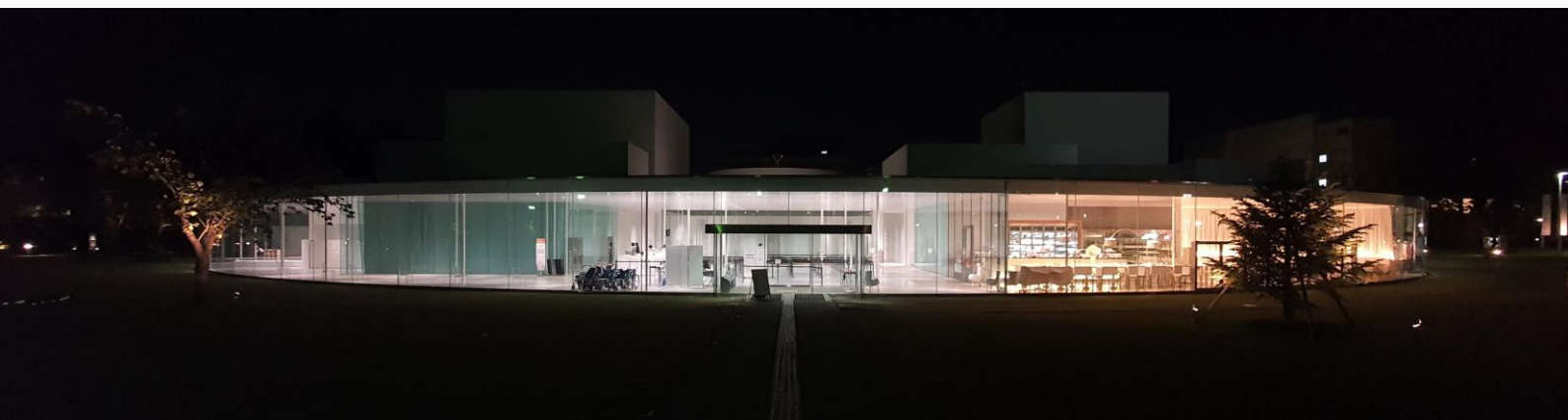

Kanazawa 21st Century

Museum of Contemporary Art

金泽21世纪美术馆

SANAA 妹岛和世 + 西泽立卫



D. T. Suzuki Museum

鈴木大拙館

Yoshio Taniguchi 谷口吉生



National Crafts Museum

国立工艺馆

Yamagishi Architects + Engineers 山岸建筑设计事务所



Yoshiro and Yoshio Taniguchi

Museum of Architecture

谷口吉郎 / 吉生纪念金泽建筑馆

Yoshio Taniguchi 谷口吉生



Kenroku-en Garden

兼六園



Kanazawa Umimirai Library

金泽海未来图书馆

Coelacanth K&H Architects 工藤和美 + 堀场弘

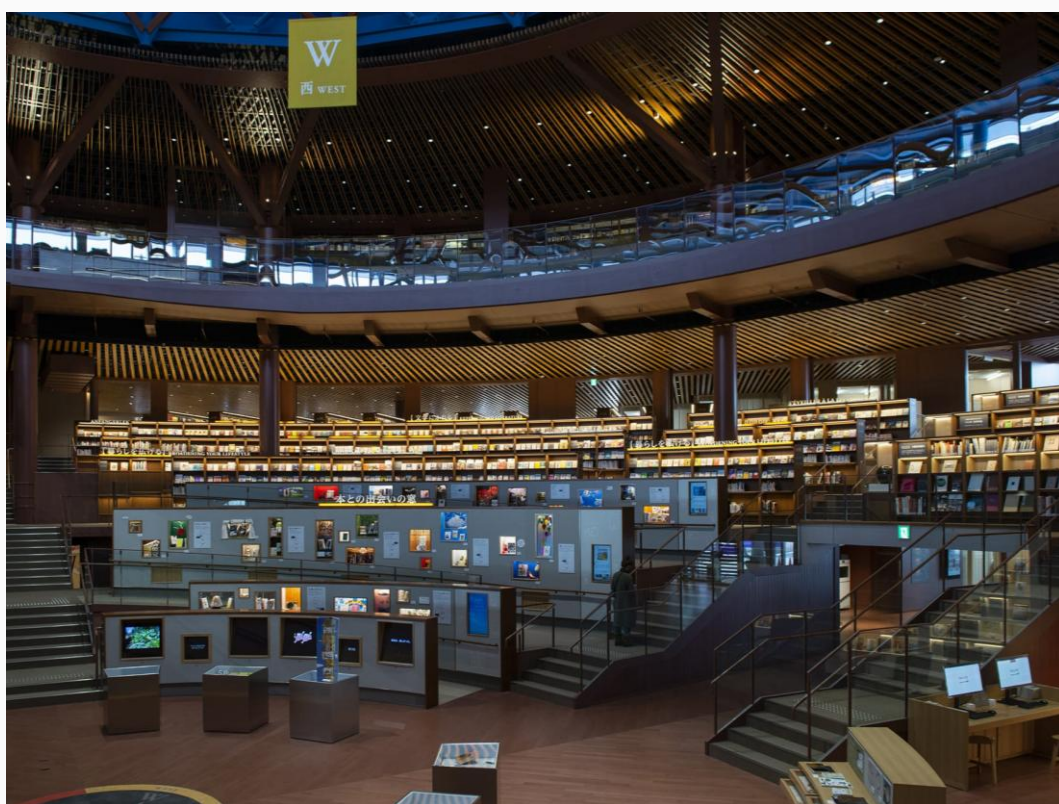

Ishikawa Prefectural Library

石川县立图书馆

Mitsuru Senda 仙田满

Learn more

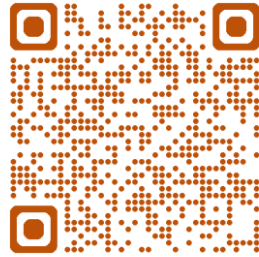

更多详情

Apply here



在此报名

Instagram



thejourneysbythespace

